



KIA OVAL
EVENTS &
ENTERTAINMENT

THE **KIA OVAL** **EXHIBITIONS**
AT THE KIA OVAL



KIA OVAL
EVENTS &
ENTERTAINMENT

EXHIBITIONS

Our Events Team will tailor a package to suit your individual exhibition requirements with a wide range of facilities including: -

- Over 1,500 m2 in one modern “blank canvas” exhibition hall for indoor displays with direct vehicular access.
- 1,088 m2 additional indoor space for expansion into our England & Ashes Suites
- Conference & Meeting rooms for visitor seminars
- Flexible catering areas for efficient dining options
- Multiple access doors for quick and easy build up and break down



JARDINE SUITE



KIA OVAL
EVENTS &
ENTERTAINMENT

The central section of the Jardine Suite is the Kia Oval's ultimate "blank canvas" room and is perfect for exhibitions of up to 25 trestle table stands. During the Summer (May to September) additional Bars will be added into the central area reducing the overall space. The capacities for both summer and winter are shown opposite.

Exhibitor Size	Winter	Summer
4ft Trestle	30	25
6ft Trestle	27	24
2m x 1m Shell Schemes	18	15
3m x 2m Shell Schemes	10	8

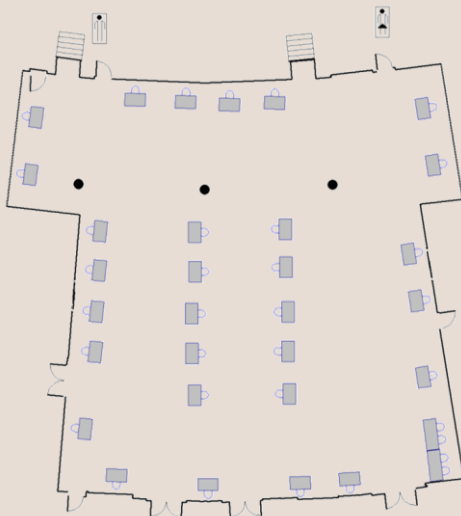

All measurements are completed in meters and are approximate.

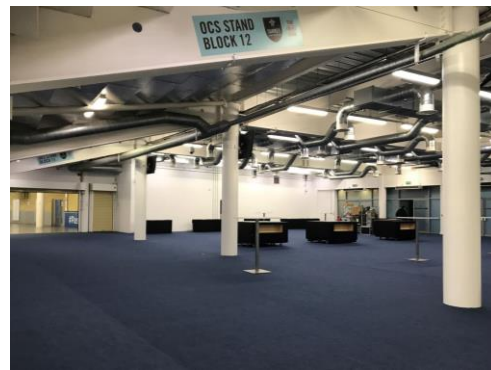

JARDINE SUITE



KIA OVAL
EVENTS &
ENTERTAINMENT

The Jardine Suite features a large central area flanked by two large wings, and is perfect for exhibitions of up to 80 shell scheme stands.

During the Summer (May to September) additional Bars will be added into the central area reducing the overall space. The capacities for both summer and winter are shown opposite.

EXHIBITOR SIZE	WINTER	SUMMER
4ft Trestle	105	100
6ft Trestle	80	75
2m x 1m Shell Schemes	80	76
3m x 2m Shell Schemes	65	63

DIMENSIONS	
Length	126
Width	24
Height	4.5
Sqm2	1549

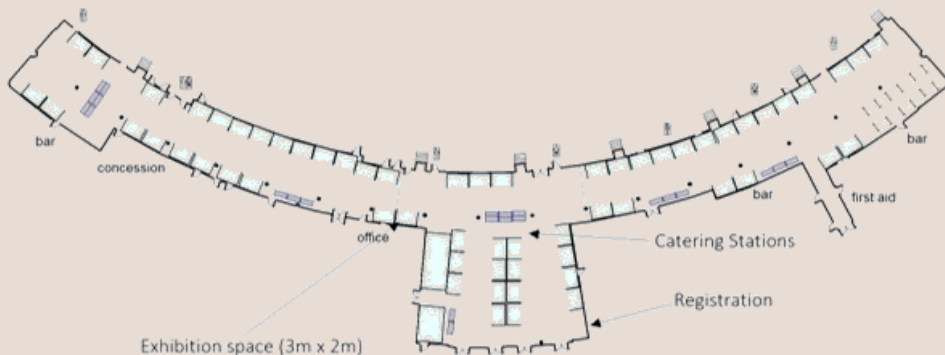

ENGLAND SUITE



KIA OVAL
EVENTS &
ENTERTAINMENT

The England Suite, is the largest purpose-built conference room in the JM Finn Stand. Capable of accommodating up to 650 guests theatre style, or 510 for a dinner, this second floor suite is one of the most versatile spaces at the Kia Oval. Doors lead directly onto the Club-Level balcony overlooking the pitch, and a wall of windows ensures natural daylight floods the room.

EXHIBITOR SIZE	QUANTITY
4ft Trestle	50
6ft Trestle	30
2m x 1m Shell Schemes	20
3m x 2m Shell Schemes	10

DIMENSIONS	
Length	29
Width	20
Height	2.5
Sqm2	606

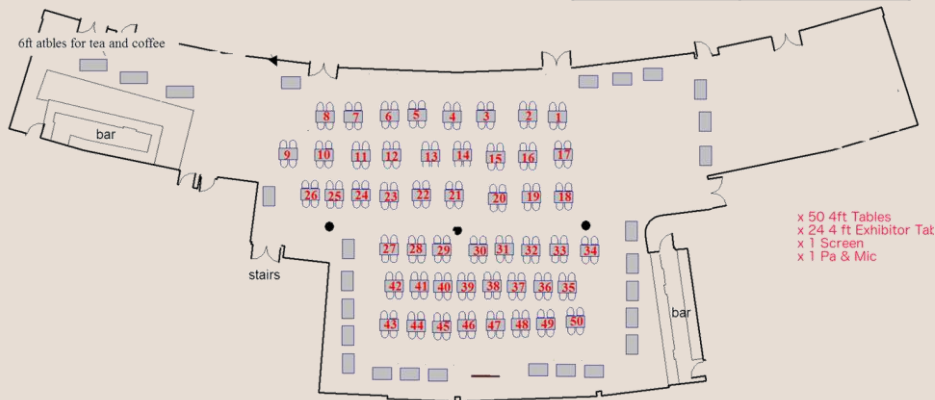

ASHES SUITE



KIA OVAL
EVENTS &
ENTERTAINMENT

The Ashes Suite, named after the famous and ancient Cricket series between England and Australia, is located on the first floor. The space can accommodate 500 guests informally, up to 300 dining or 340 theatre style. With a wall of windows overlooking the pitch, the room features an abundance of natural daylight and has complimentary high-speed Wi-Fi for all your delegates.

SET-UP TYPE	QUANTITY
4ft Trestle	40
6ft Trestle	25
2m x 1m Shell Schemes	15
3m x 2m Shell Schemes	8

DIMENSIONS	
Length	23
Width	20
Height	2.7
Sqm2	482

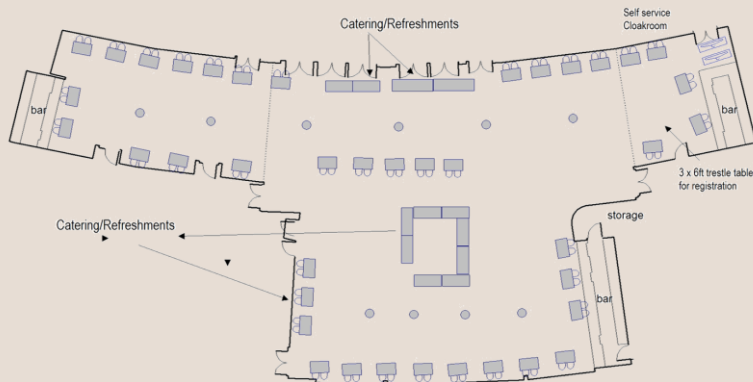

STANDS & SHELL SCHEMES



KIA OVAL
EVENTS & ENTERTAINMENT

SHELL SCHEME PACKAGES	
Platinum Stand	£2,250
Gold Stand	£1,865
Silver Stand	£1,700
Bronze Stand 1	£1,300
Bronze Stand 2	£1,100
REGISTRATION DESKS	
Platinum Reg Desk – With Canvas	£1,790
Platinum Reg Desk – With Plain Backdrop	£1,160
Gold Reg Desk – With Canvas	£1,640
Gold Reg Desk – With Plain Backdrop	£1,160
Silver Reg Desk	£690
Bronze Reg Desk	£510
ADD ON'S	
Screen Podium	£150
Brochure Stand	£350

For More Information please contact:
Neil Drysdale- Technical Events Manager
Neil.Drysdale@PSAV.COM
 +44 (0) 20 7820 5714
 +44 (0) 7387 261 092



PLATINUM STAND



KIA OVAL
EVENTS &
ENTERTAINMENT



The premium stand makes your brand stand out from the crowd with maximum branding opportunities in both print and digital formats.

- Two Company Logos
- Three Areas for Printed Branding
- Literature Rack
- Sub Floor with Carpet
- 48" HD LED Monitor
- HDMI Cable

For More Information please contact:

Neil Drysdale

Technical Events Manager

Neil.Drysdale@PSAV.COM

+44 (0) 20 7820 5714

+44 (0) 7387 261 092

AVC
A PSAV COMPANY



GOLD STAND



KIA OVAL
EVENTS &
ENTERTAINMENT



A high-end stand that is sure to make an impact with a combination of print and digital.

- Two Company Logos
- One Area for Printed Branding
- Literature Rack
- Sub Floor with Carpet
- 48" HD LED Monitor
- HDMI Cable

For More Information please contact:

Neil Drysdale

Technical Events Manager

Neil.Drysdale@PSAV.COM

+44 (0) 20 7820 5714

+44 (0) 7387 261 092



SILVER STAND



KIA OVAL
EVENTS &
ENTERTAINMENT



A Compact stand with printed branding opportunities.

- Two Company Logos
- Two Areas for Printed Branding
- Literature Rack
- Sub Floor with Carpet

For More Information please contact:

Neil Drysdale

Technical Events Manager

Neil.Drysdale@PSAV.COM

+44 (0) 20 7820 5714

+44 (0) 7387 261 092



A PSAV COMPANY

BRONZE STAND 1



KIA OVAL
EVENTS &
ENTERTAINMENT



A low cost, high impact solution with a digital offering..

- One Company Logo
- One Area for Printed Branding
- 48" HD LED Monitor
- HDMI Cable
- Sub Floor with Carpet

For More Information please contact:

Neil Drysdale

Technical Events Manager

Neil.Drysdale@PSAV.COM

+44 (0) 20 7820 5714

+44 (0) 7387 261 092



A PSAV COMPANY

BRONZE STAND 2



KIA OVAL
EVENTS &
ENTERTAINMENT



A low cost, high impact solution with printed branding.

- One Company Logo
- One Area for Printed Branding
- Literature Rack
- Sub Floor with Carpet

For More Information please contact:

Neil Drysdale

Technical Events Manager

Neil.Drysdale@PSAV.COM

+44 (0) 20 7820 5714

+44 (0) 7387 261 092



AV ADDITIONS



KIA OVAL
EVENTS &
ENTERTAINMENT

AUDIO	
Small PA System – for up to 50 delegates, Includes one microphone TOTAL SYSTEM PRICE	£145
Large PA System - for up to 200 delegates, TOTAL SYSTEM PRICE	£180
Hand held Microphone *PA System Needed*	£65
Lapel Microphone *PA System Needed*	£65
Conference Telephone (up to 15 delegates boardroom style only)	£86
VISUAL	
HD 46" LED/LCD Screen with Speakers & Stand	£190
HD 55" LED/LCD Screen with Speakers & Stand	£300
HD 75" LED/LCD Screen with Speakers & Stand	£515
55" Comfort monitor with Stand	£205

For More Information please contact:
Neil Drysdale- Technical Events Manager
Neil.Drysdale@PSAV.COM
 +44 (0) 20 7820 5714
 +44 (0) 7387 261 092



AV ADDITIONS



KIA OVAL
EVENTS &
ENTERTAINMENT

MISCELLANEOUS	
Mac Book Pro 15"	£162
iPad 32GB Wifi	£80
Laptop c/w Office	£110
Remote Presenters Mouse	£11
Flipchart Easel	£15
Flipchart Easel, Pens & Paper	£25
Laser pointer	£10
Conference lectern	£60
10m 4-Way Mains Extension	£10
Display Board	£45
TECHNICIAN - Weekday rate (Up to 12 Hours)	£375
Power to stands (per stand) – up to 10 power units	£15
Power to stands (per stand) – over 10 power units	Bespoke Cost
Extension Cables	£10.50

For More Information please contact:
Neil Drysdale- Technical Events Manager
Neil.Drysdale@PSAV.COM
 +44 (0) 20 7820 5714
 +44 (0) 7387 261 092



FOOD OPTIONS



KIA OVAL
EVENTS &
ENTERTAINMENT

ITEM	PER PERSON COST
Canapes: 3 x Choice of canapes Additional Canape £4.75 each	£14.25
Bronze Lunch: Two main protein topped salads. With warmed new potatoes drizzled in olive oil and chives, and two nutritional cold salads.	£17.85
Hot Snacks: 3 x Hot snack items	£18.50
Bowl Food: 3 x Bowl Food Items (1 Hot, 1 Cold, and 1 Dessert) Additional Bowl £8.00 each	£24.00
Silver menu: 4 choice finger food menu with two salads	£29.70
Sit Down: 2 Course Sit Down Meal	£32.90
Gold Menu: Premium hot choice menu (3 choices) with two choice desserts with two salads	£33.50
Sit-Down: 3 Course Sit Down Meal	£37.90

All prices are per person and exclude VAT

All dietary requirements must be provided at least 5 full working days prior to the event start date.

Please be aware we cannot guarantee trace-free food - if you require allergen information please contact a member of staff on the day.



TEA & COFFEE



KIA OVAL
EVENTS &
ENTERTAINMENT

Per serving 3.45

Fairtrade coffee and speciality teas

Unlimited all day 15.10

Fairtrade coffee and speciality teas

With homemade biscuits 4.40

Selection of homemade biscuits

With mini muffin selection 5.25

Selection of mini muffins

With artisan pastries 5.65

All butter artisan pastries

With brioche bacon or sausage roll 6.60

Served with tomato ketchup and brown sauce

With brioche egg roll 5.65

Served with tomato ketchup and brown sauce

With fruit basket 5.45

Whole fruit pieces

With granola 10.20

Served with honey, dried fruits and nuts, soft berries, fruit yoghurts

Light Afternoon Tea 11.65

Homemade scones served with Cornish clotted cream, strawberry preserve, Tea Cakes

Full Afternoon Tea 21.90

Selection of sandwiches in gourmet breads, scones served with Cornish clotted cream, hedgerow jams, A variety of tea cakes and a selection of macaroons



All prices are per person and exclude VAT

All dietary requirements must be provided at least 5 full working days prior to the event start date.

Please be aware we cannot guarantee trace-free food - if you require allergen information please contact a member of staff on the day.

JARDINE CONCESSIONS



KIA OVAL
EVENTS &
ENTERTAINMENT

There are 5 built in concessions units in the Jardine Suite which are able to sell both hot and cold food to your guests. These are marked with stars on the below plan with one unit (marked with a yellow star) containing its on cooking equipment. These units can be opened on a minimum spend per day.

COSTS	
Catering facility open serving hot & cold food that delegates can purchase	£1,200 + VAT
Catering facility open serving cold food that delegates can purchase	£800 + VAT
Bar Facility (per bar)	£800 + VAT



All measurements are completed in meters and are approximate.





KIA OVAL
EVENTS &
ENTERTAINMENT

SUSTAINABILITY

We believe that sustainability should be at the heart of what we do. To ensure we are holding ourselves accountable we have set ourselves objectives for 2020:

- Successful introduction of compostable waste streams throughout the ground
- Continue eradication of single use plastic
- Reduce our carbon footprint and continue to innovate in green areas
- Communicate our goals to fans and guests while leading the sports sustainability agenda.

If there is any areas that we could improve on or you have any ideas, please get in contact at: sustainability@kiaoval.com



ACCESS



KIA OVAL
EVENTS &
ENTERTAINMENT

Changing Places Facility:

- For those who need extra equipment and space to allow them to use the toilets safely and comfortably we have a Changing Places facility located on the 1st floor of the JM Finn stand.

Deaf or Hard of Hearing Guests:

- Induction loops can be temporarily installed in all rooms free of charge at the prior request of the event organiser; induction loops are also installed at all receptions and security areas which can be accessed by switching a hearing aid to M or T.

Those with Ambulant disabilities:

- Conference parking for Blue badge holders is available, please contact your sale person to book this in.
- Accessible toilet facilities are available throughout the ground with the majority requiring a RADAR key. If you are not in possession of such a key then contact the nearest reception who will source one for you immediately.
- Emergency cords are situated in all accessible toilets.

Additional Information:

- 95% of all internal areas are wheelchair friendly
- Should you have any queries regarding access then please contact our Accessibility Liaison Officer, Theresa Peters, on tpeters@surreycricket.com for further information.



LOCATION

- Complimentary parking for organisers
- Outside the congestion Charge Zone
- On London's Super Cycle Highway
- Walking Distance from 4 underground stations
- Close to the Over ground station
- 10 minutes from Bank Underground

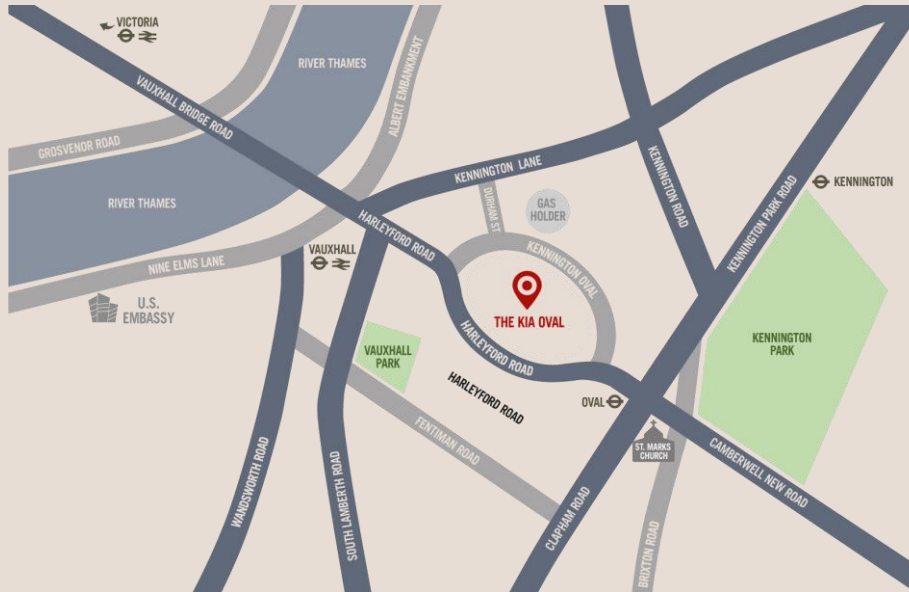



TESTIMONIALS

"We have used The Kia Oval for various events and have always been very happy with the service we have received. I cannot single out one event as all have been handled with the utmost professionalism and 'can do' approach. From the start of the booking process to the end of the event, The Kia Oval team are always courteous, accommodating and willing to make it work for the client. The roof top area is a great addition to the event space and we've been lucky enough to have used it twice and our Partners enjoyed the experience of being able to overlook the grounds with a drink in hand! If we have a large event, The Kia Oval is always our first thought as its 'TNT.....Tried n' Trusted'!"

PA to Customer Director, JOHN LEWIS

"Everyone commented and said it was the best managers meeting by far....they loved the food."

EA to Senior Vice President, ADECCO



@KiaOvalEvents

0207 820 5670

enquiries@kiaoval.com



KIA OVAL
EVENTS &
ENTERTAINMENT